

Separate catalog available

## ATC II -300S/D

Cost-efficient model that supports limited-changeover molding, long-distance transport, and low clearance



Clamping force 200 - 350 tf

**S** Standard

**LOW** Low posture (Double speed mechanism)

Servo + Air-driven

All-Axis Servo Driven Type

Single-Axis Servo Driven Type

Swing Type

Side Entry Type

For Vertical Molding Machine

Stock System

Product Series Guide [P11]

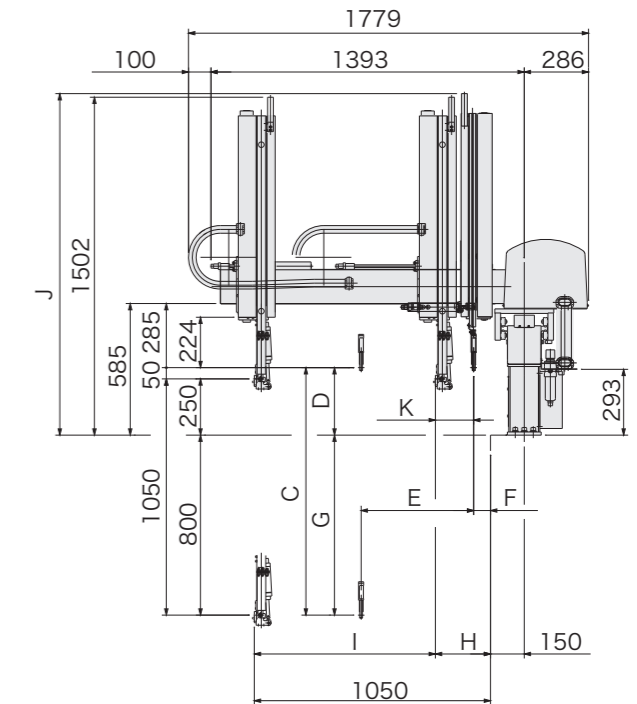
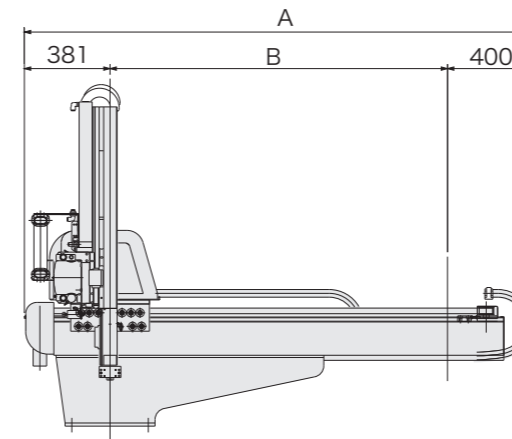

### Hybrid Robot with Outstanding Cost Efficiency and Low-Profile Design

The ATCII-300 is a low-profile, single-axis servo-driven type take-out robot that adapts to low-clearance plants. These cost-efficient models are designed to suit molding machines with a clamping force of 200 to 350 tf. The lightweight hand-held GIIIB-type controller comes with the robot as a standard feature.

#### Standard Specifications

Power supply	Drive method	Controller model	Working air pressure	Flip angle
200/220 VAC (50/60 Hz) Single phase	Digital servo motor (1-axis) air cylinder (Max. 4-axis)	GIIIB-type controller	0.49MPa	90°

Model	Power consumption	Traverse stroke (mm)	Kick stroke (mm)		Vertical stroke (mm)		Air consumption (NL/cycle)	Payload (kg)	Target IMM clamp capacity (tf)
			Main arm	Sub arm	Main arm	Sub arm			
ATCII-300S	0.6 kVA 200 VAC 3.0 A	1500 (1700) (1900)	250	—	1050	—	30	8	200-350
ATCII-300D				150		1100			

S type : Robot is equipped with main arm only. D type : Robot is equipped with main arm and sub arm.

( ) : Modified stroke

Payload includes the end-of-arm tool.

(mm)

Model	A	B	C	D	E	F	G	H	I	J	K
ATCII-300S	2281 (2481) (2681)	1500 (1700) (1900)	—	—	—	—	—	85	965	—	—
ATCII-300D			1100	300	500	75	800	245	805	1518	170

( ) : Modified stroke