

ATC-150S/D

■ Features



50–220 tf



Single-axis (Traverse axis)



Single support type



G II B-type controller

Hybrid Robot with Outstanding Price Performance and Low-Profile Design

The ATC-150 is a hybrid robot with a servo-powered traverse axis and pneumatic vertical and kick axes, and fast, 1-stage (non-telescopic) arms for a lower profile to fit low-clearance plants. Its lightweight handheld G II B controller has a highly visible LCD display and includes an SD memory card port for backing up or sharing data. The ATC-150 is available in S (main arm only) or D (main and sub arms) configurations and fits 50 to 220 tf molding machines.

■ Standard Specifications

Power source	Driving method	Control method	Air pressure	Maximum allowable air pressure (factory)	Wrist flip angle
AC200V (50/60Hz)	digital servo (single axis) air cylinder (max 4 axes)	Micro computer control	0.49MPa	0.70MPa	90 deg.

Model	Power consumption	Traverse stroke (mm)	Kick stroke (mm)		Vertical stroke (mm)		Air consumption (NL/cycle)	Payload	Clamping force (tf)
			Main arm	Sub arm	Main arm	Sub arm			
ATC-150S	S type/D type 0.6kVA AC200V 3.0A	(1000) 1400 <1700> 《1900》	150	—	800	—	19	Less than 3kg	50 ~ 220
ATC-150D			—	100		850			

S type: Robot is equipped with product take-out arm only. D type: Robot is equipped with product take-out arm and runner take-out arm.
 () Traverse 1000 mm, option < > Type L, << >> Type LL
 Payload includes the end-of-arm tool.



PAT.

■ Dimensions (mm)

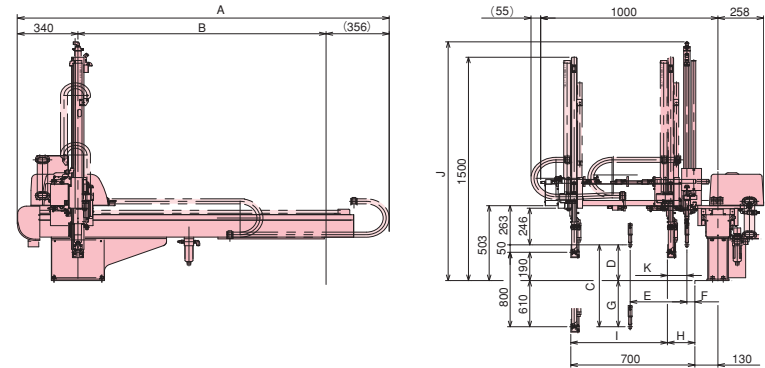

Model	A	B	C	D	E	F	G	H	I	J	K
ATC-150S	(1696) 2096	(1000) 1400	—	—	—	—	—	80	620	—	—
ATC-150D	<2396> 《2596》	<1700> 《1900》	850	240	320	45	610	155	545	1604	110

() Modified < > Type L, << >> Type LL