

# 1 All-Axis Servo Driven Type Take-Out Robot

FRA-1530S/D/DS

## FRA-1530S/D/DS

IoT technique contributes to high-precision take-out and improved productivity  
Latest technology helps solve problems at the production site

Separate catalog available

- All-Axis Servo Driven Type
- Swing Type
- Side Entry Type
- For Vertical Molding Machine
- Stock System

- All-Axis Servo Driven Type
- Swing Type
- Side Entry Type
- For Vertical Molding Machine
- Stock System

Product Series Guide [P11]

Product Series Guide [P11]



**CE**  
For CE supported languages, please contact our sales department.

**Clamping force 150 - 300 tf**

**High precision** (Advanced vibration control)  
**Optimized design + Power-saving**

**Low posture** (Double speed mechanism)  
**All-axis servo-driven**

**Remote monitoring**

**PAT.**



### Active Vibration Control

The FRA senses its own vibrations and eliminates them automatically. Equipped with the world's most advanced vibration control technology that enables a variety of operations with speed and accuracy such as insert molding, which demand repeatability.

### IoT system "INTU LINE"

INTU LINE displays production counts, uptime ratio, operation status, cycle times, error counts, stoppage log, and production floor photos. When trouble occurs, the FRA's IoT system shares your robot's error data with Yushin to help service personnel diagnose the problem.

### New controller "E-touch V"

The E-touch V is designed with ergonomics in mind and is presented in a vertical, dual screen format with main and sub screens, allowing the use of smartphone-like touch controls.

### Standard Specifications

Power supply		Drive method		Controller model		Working air pressure		Flip angle		
3 phase AC200/220/230 V (50/60 Hz)		Digital servo motor 3/5-axis		E-touch V		0.49 MPa		90°		
Model	Power consumption	Traverse stroke [mm]	Kick stroke [mm]		Vertical stroke [mm]		Air consumption [NL/cycle]	Payload [kg]	Noise [dBA]	Target IMM clamp capacity [tf]
			Main arm	Sub arm	Main arm	Sub arm				
FRA-1530S	2.3 kVA AC200 V 6.5 A	(1100) 1500 (1700) (1900) (2200) (2500)	728	—	—	—	5.9 ECO Vacuum OFF 1.9 ECO Vacuum ON	5 (11)	72.7	150-300
FRA-1530D			668	668	850 (1100) (1300) (1550)	850 (1100) (1300) (1550)				
FRA-1530DS	3.8 kVA AC200 V 10.8 A	(2500)	544	544	—	—	11.6 ECO Vacuum OFF 3.6 ECO Vacuum ON			

S type : Robot is equipped with main arm only. D type : Robot is equipped with main arm and sub arm. DS type : Robot is equipped with two main arms.  
( ) : Modified stroke < > : Increased maximum payload  
Payload includes the end-of-arm tool.

### Rear (Non-operator) Side Discharge Direction [mm]

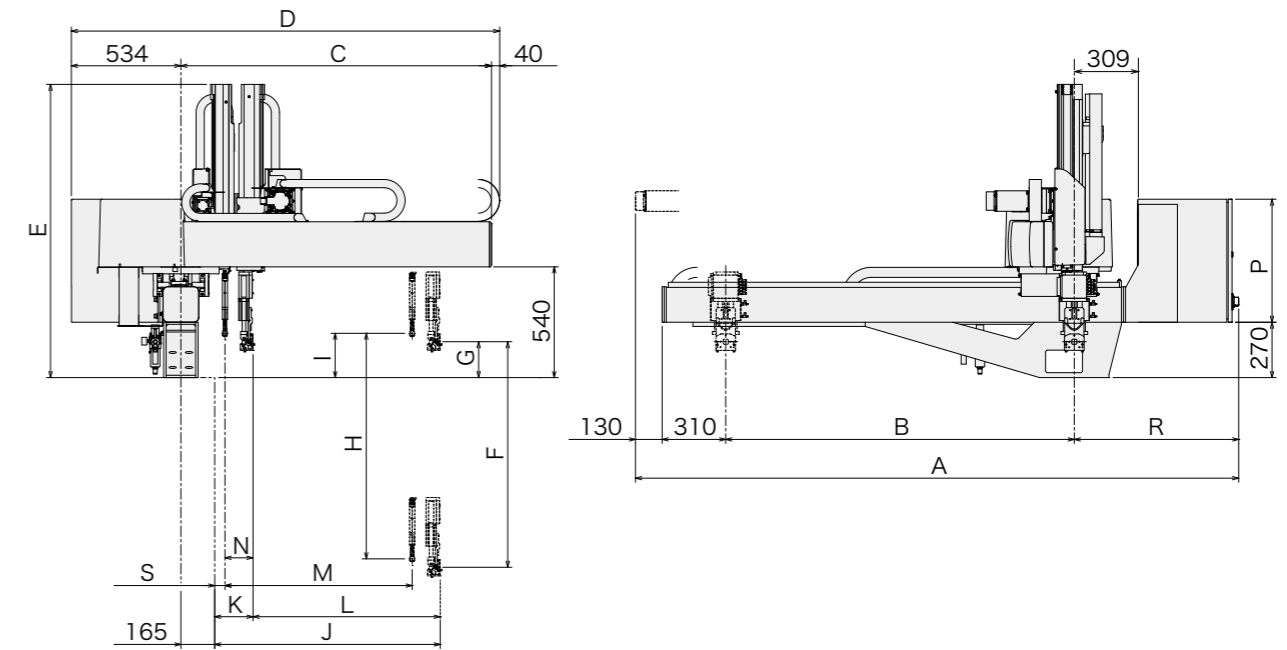

### Operator Side Discharge Direction [mm]

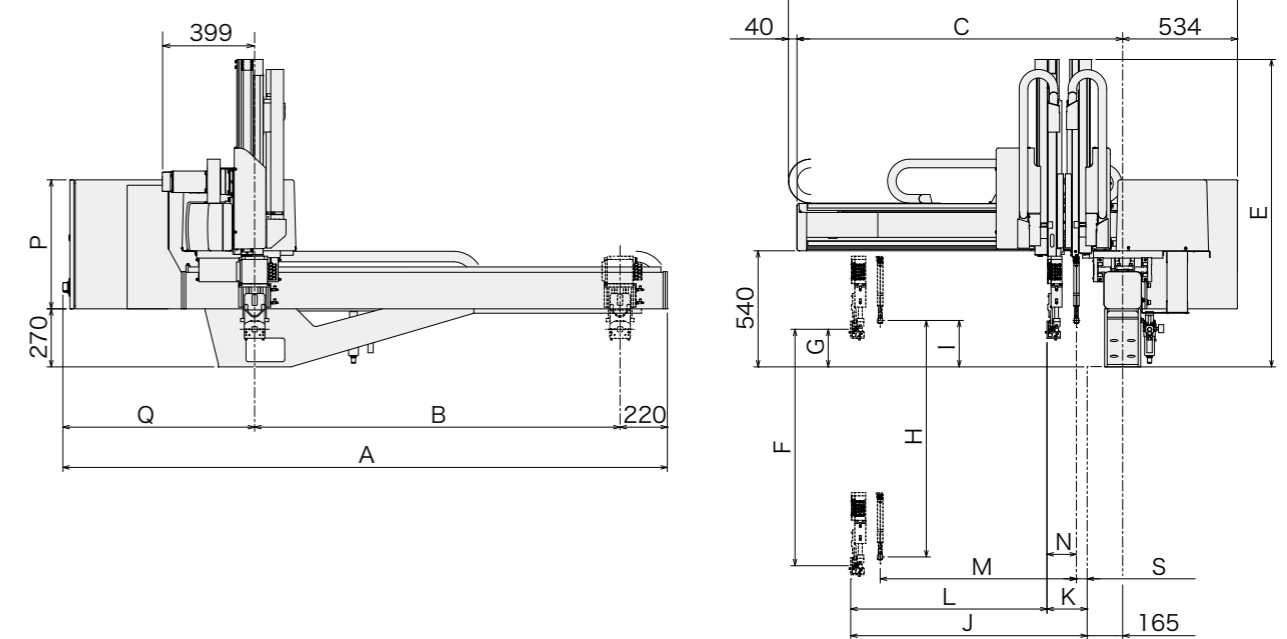

Model	A[Rear Side]		B	C	D	E	F	G	H	I	J	K	L	M	N	S	P	Q	R
	C2 type	C1 type																	
FRA-1530S	(2342)	(2310)	(1100)			1254	850		—	—		122	728	—	—	50			
FRA-1530D	(2942)	(2910)	(1700)	1265	1839	(1430)	(1100)	293	850	335	850	182	668	668	132				
FRA-1530DS	(3442)	(3410)	(2200)			(1534)	(1300)		(1100)			306	544	544	178	128			
	(3742)	(3710)	(2500)			(1662)	(1550)		(1300)			293							

A[Operator Side]		G	I	K	L	M	N
C2 type	C1 type						
(2212)	(2180)			<122>	<728>	—	—
2612	2580			<182>	<668>	<668>	<132>
(2812)	(2780)			<245>	<605>	<605>	<195>
(3012)	(2980)	<175>	<175>	<215>	<635>	<635>	<165>
(3312)	(3280)			<306>	<554>	<554>	<178>
(3612)	(3580)			<417>	<434>	<434>	<289>
				<338>	<512>	<512>	<210>

- ( ) : Modified stroke
- < > : With increased wrist flip torque
- { } : With horizontal wrist rotation unit
- < > : With centralized automatic (manual) lubrication system

FRA-1530S/D/DS

All-Axis Servo Driven Type Take-Out Robot