

1 All-Axis Servo Driven Type Take-Out Robot

HST-400S/D/DS

Separate catalog available

HST-400S/D/DS

Lighter, faster construction achieves shorter settling time with a focus on improving productivity

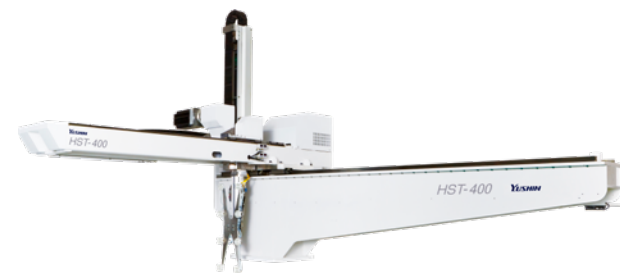

* Robots are available in 2 different colors.



For CE supported languages, please contact our sales department.

Clamping force 280 - 450 tf

High speed

Vibration control

Optimized design

Low posture (Double speed mechanism)

All-axis servo-driven

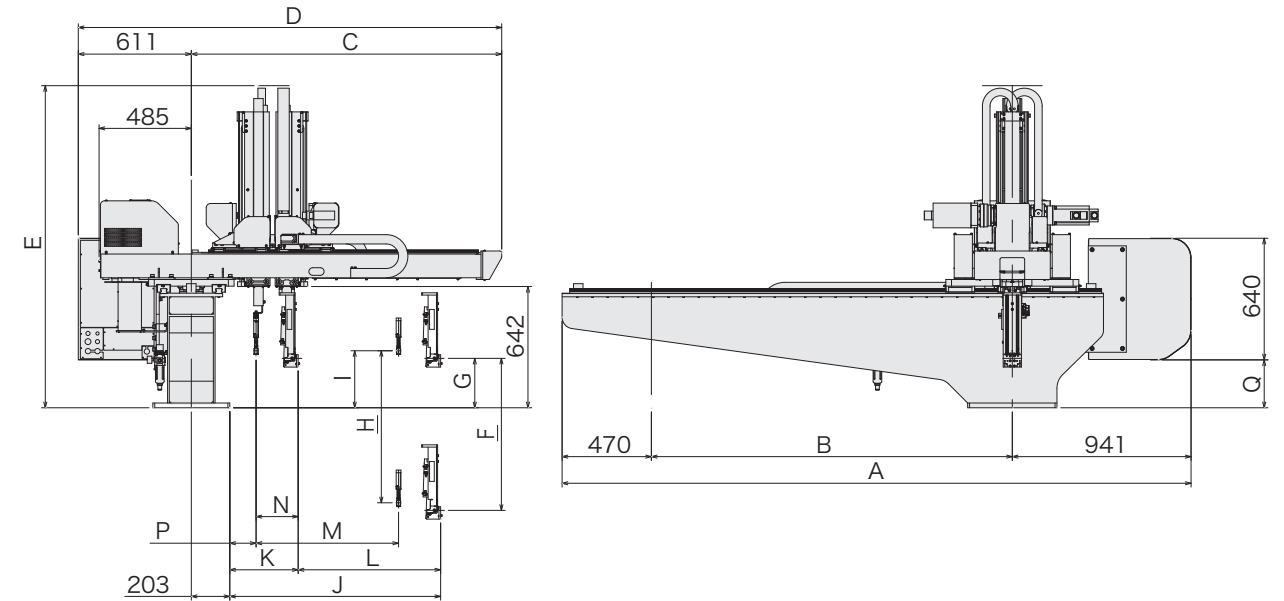

[mm]

Model	A	B	C	D	E	F	G	H	I	J	K	L	M	N	P	Q
HST-400S	3111 (3311) (3611) (3911)	1700 (1900) (2200) (2500)	1634	2245	1695 (1787)	1100 (1300)	260	-	-	1110	160	950	-	-	139	252
HST-400D								1100 (1300)	300		360	750	750	222		
HST-400DS			1734	2345					260	1210		850	850	269	91	

() : Modified stroke

Built Lighter & Faster

The shape and structure of most HST components were formed with design optimization technology for lighter weight. This innovation trimmed 72.5 kg from the HST's moving components, making it 25.4% lighter than the previous series. The HST achieves 9.2% faster speeds than the previous series without a motor size increase.*1

Shorter Settling Times Design Optimization + CFRP + Anti-Vibration Controls

The HST's extensive design optimization studied traits including natural oscillation and damping characteristics to dramatically improve vibration control. Settling time (time required for oscillations to calm down to within a set value) was reduced by 98.6%.*2

*1 Measured on the HST-400

*2 Measured on the HST-150

Standard Specifications

Power supply	Drive method	Controller model	Working air pressure	Flip angle					
200/220/230 VAC (50/60 Hz) 3 phase	Digital servo motor 3/5-axis	E-touch II/ E-touch compact-YC	0.49MPa	90°					
Model	Power consumption	Traverse stroke [mm]	Kick stroke [mm]		Vertical stroke [mm]		Air consumption [NL/cycle]	Payload [kg]	Target IMM clamp capacity [tf]
			Main arm	Sub arm	Main arm	Sub arm			
HST-400S	6.0 kVA 3 phase 200 VAC 17.3 A Max.	1700 (1900) (2200) (2500)	950	-	-	-	5.4	10	280-450
HST-400D	8.0 kVA 3 phase 200 VAC 23.1 A Max.		750	750	1100 (1300)	1100 (1300)			
HST-400DS	9.0 kVA 3 phase 200 VAC 26.0 A Max.		850	850	-	-			

S type : Robot is equipped with main arm only. D type : Robot is equipped with main arm and sub arm. DS type : Robot is equipped with two main arms.

() : Modified stroke

Payload includes the end-of-arm tool.

Introducing our EXTRA catalog

Needs on the molding work floor

- Flexible handling of products
- Flexible cutting of products
- Round-the-clock operation and better labor saving
- Changeover improvement

Yushin has the solution for you. [WEB](#) [CATALOG YUSHIN](#)

HST-400S/D/DS

All-Axis Servo Driven Type Take-Out Robot