

Separate catalog available

RC2-3550S/D-SE

Offering speed, reliability and energy savings with a wide range of scalable functions



For CE supported languages, please contact our sales department.

Clamping force 350 - 500tf

Vibration control

Power-saving

Low posture (Double speed mechanism)

All-axis servo-driven

Developed to achieve "high-speed, high-rigidity," "downtime reduction," and "running cost reduction."

- Compressed air economizing tool Smart ECO Vacuum
Yushin has refined our unique ECO Vacuum technology to reduce compressed air consumption even further. Smart ECO Vacuum monitors vacuum pressure continuously to optimize suction timing. As a result, robot air consumption can be economized by as much as 78%, which can lead to lower electricity costs for air compressors and reduced capital expenditures.
- Productivity improvement
Faster, more accurate high-speed take-out with standard machines
High-rigidity vertical and kick units ensure fast, accurate operations.
- E-touch II
Equipped with easy-to-use E-touch II controller with 10.4-inch display for intuitive operation.

Standard Specifications

Power supply	Drive method	Controller model	Working air pressure	Flip angle					
200/220 VAC (50/60 Hz) 3 phase	Digital servo motor 3/5-axis	E-touch II	0.49MPa	90°					
Model	Power consumption	Traverse stroke [mm]	Kick stroke [mm]		Vertical stroke [mm]		Air consumption [NL/cycle]	Payload [kg]	Target IMM clamp capacity [tf]
			Main arm	Sub arm	Main arm	Sub arm			
RC2-3550S-SE	2.7 kVA 3 phase 200 VAC 7.6 A	1700 (1900) (2200) (2500)	978	—	1100 (1300) (1550)	—	11.7 Smart ECO Vacuum OFF 3.1 Smart ECO Vacuum ON	10 (13)	350-500
RC2-3550D-SE	3.6 kVA 3 phase 200 VAC 10.4 A		918	918		1100 (1300) (1550)			

S type : Robot is equipped with main arm only. D type : Robot is equipped with main arm and sub arm.
Stanchion is standard equipment for 2,200 mm or longer traverse stroke.
() : Modified stroke (<) : Increased maximum payload
Payload includes the end-of-arm tool.

Rear (Non-operator) Side Discharge Direction (mm)

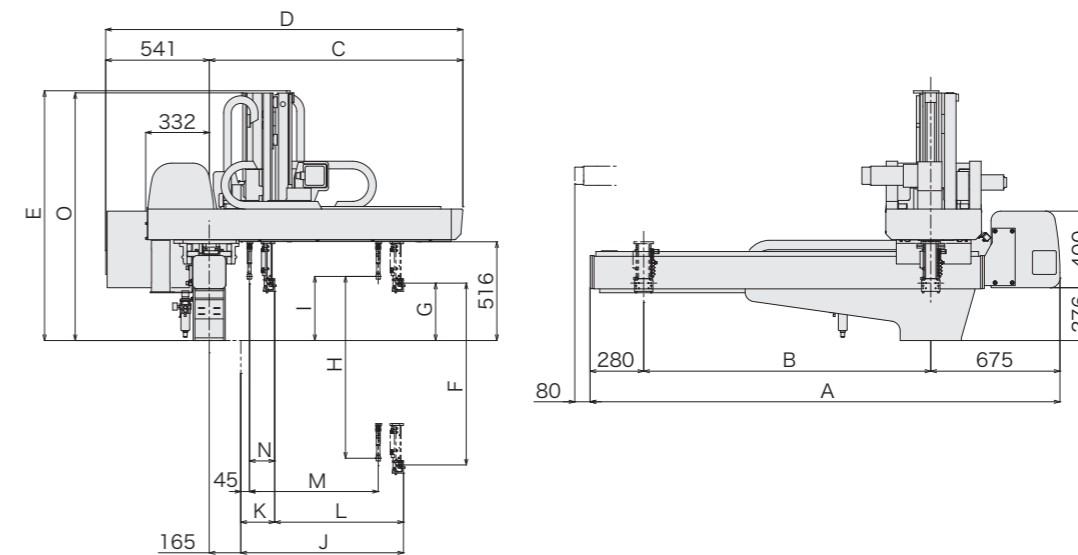

Operator Side Discharge Direction (mm)

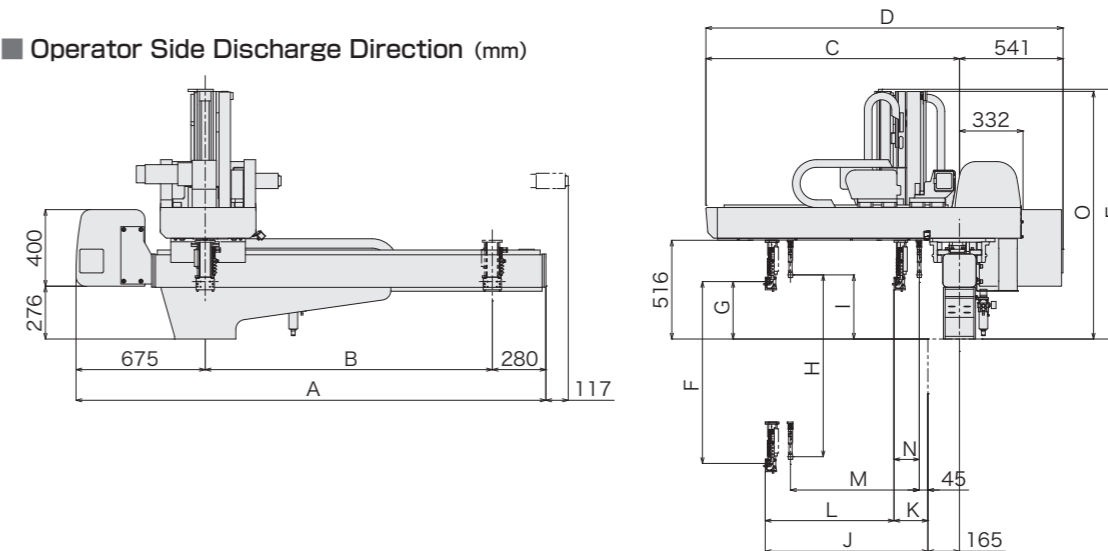

[mm]

Model	A	B	C	D	E	F	G	H	I
RC2-3550S-SE	2655 (2855) (3155) (3455)	1700 (1900) (2200) (2500)	1575	2116	1380 (1480) (1605)	1100 (1300) (1550)	176	—	—
RC2-3550D-SE								1100 (1300) (1550)	216

Model	J	K	L	M	N	O
RC2-3550S-SE	1100	122	978	—	—	—
RC2-3550D-SE		182	918	918	137	1374 (1470) (1598)

Controller (mm)

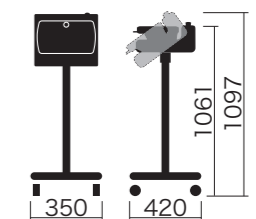

() : Modified stroke

(Adjustable viewing angle feature is optional.)