

1 All-Axis Servo Driven Type Take-Out Robot

RCII-400S/D

RC II -400S/D

Offering speed, reliability, and energy savings with a wide range of scalable functions



For CE supported languages, Please contact our sales department.

Clamping force 280 - 550tf

High end

Vibration control

Power-saving

Low posture
(Double speed mechanism)

All-axis servo-driven

Developed on the Basic Concepts of Speed, Reliability, and Efficiency

- **High-speed**
Completely redesigned arm and kick units dramatically reduce take-out time compared to previous models.
- **Reliability**
Increased rigidity of the take-out robot and vibration damping applied to the arm delivers steady take-out and release action.
- **Energy saving**
The standard-equipped ECO Vacuum reduces air consumption while manipulating molded parts to lower operating costs for the user.
- **E-touch II**
The RC series' advanced E-touch II features a 10.4-inch full-color touch screen for easy operation.

Standard Specifications

Power supply	Drive method	Controller model	Working air pressure	Flip angle					
200/220 VAC (50/60 Hz) 3 phase	Digital servo motor 3/5-axis	E-touch II	0.49MPa	90°					
Model	Power consumption	Traverse stroke (mm)	Kick stroke (mm)		Vertical stroke (mm)		Air consumption (NL/cycle)	Payload (kg)	Target IMM clamp capacity (tf)
			Main arm	Sub arm	Main arm	Sub arm			
RCII-400S	2.7 kVA 3 phase 200 VAC 7.6 A	1700 (1900) (2200) (2500)	978	—	1100 (1300) (1550)	—	11.7 (ECO Vacuum OFF)	10 (13)	280-550
RCII-400D	3.6 kVA 3 phase 200 VAC 10.4 A		918	918		1100 (1300) (1550)			

S type : Robot is equipped with main arm only. D type : Robot is equipped with main arm and sub arm. Stanchion is standard equipment for 2,200 mm or longer traverse stroke.
() : Modified stroke () : Increased maximum payload Payload includes the end-of-arm tool.

Separate catalog available

■ Rear (Non-operator) Side Discharge Direction (mm)

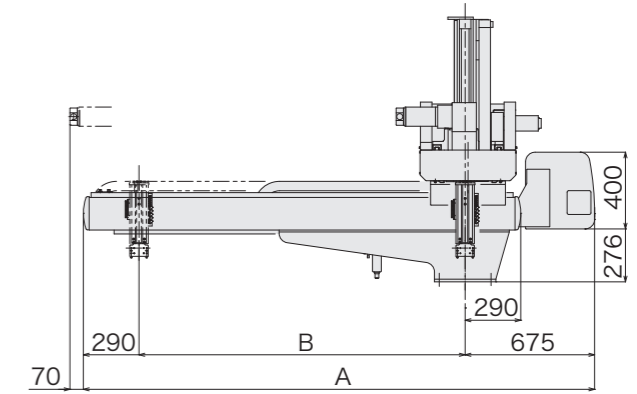
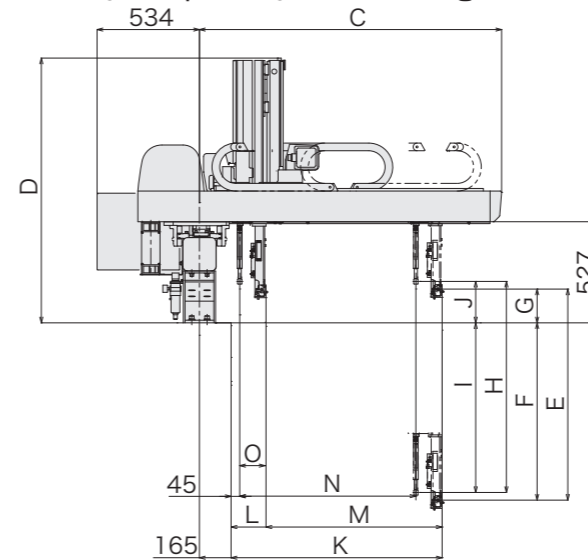

■ Operator Side Discharge Direction (mm)

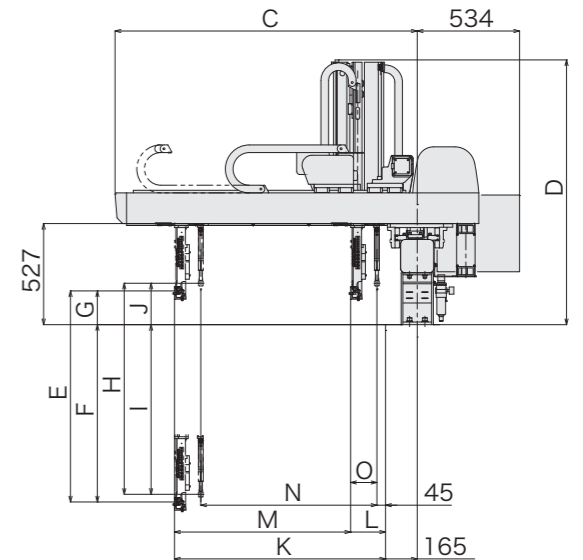
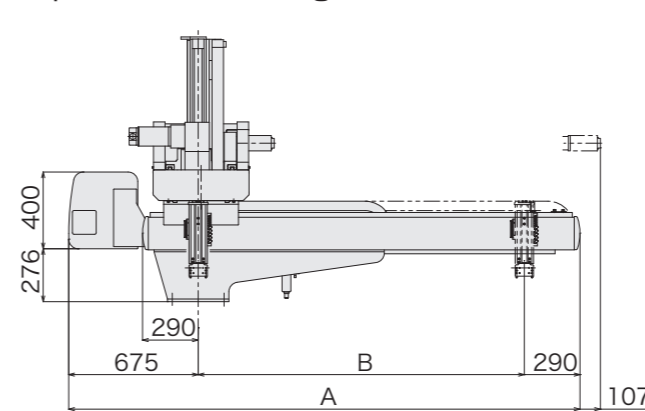

(mm)

Model	A	B	C	D	E	F	G	H	I
RCII-400S	2665 (2865) (3165) (3465)	1700 (1900) (2200) (2500)	1575	1380 (1480) (1605)	1100 (1300) (1550)	924 (1124) (1374)	176	—	—
RCII-400D								1100 (1300) (1550)	884 (1084) (1334)

Model	J	K	L	M	N	O
RCII-400S	—	1100	122	978	—	—
RCII-400D	216		182	918	918	137

■ Controller (mm)

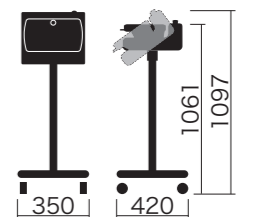

() : Modified stroke

Adjustable viewing angle feature is optional.

RCII-400S/D

All-Axis Servo Driven Type Take-Out Robot