

All-Axis Servo Driven Type

Single-Axis Servo Driven Type

Swing Type

Side Entry Type

For Vertical Molding Machine

Stock System

Product Series Guide [P11]

RC-30S/D

Offering speed, reliability, and energy savings with a wide range of scalable functions

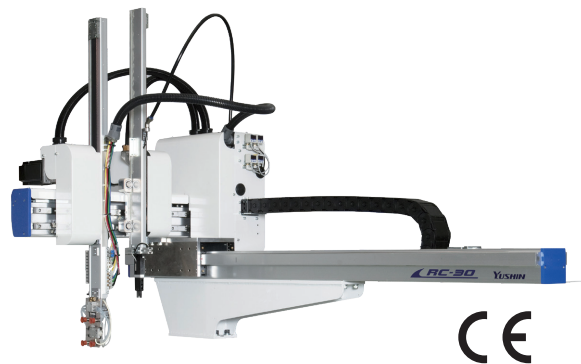

For CE supported languages, Please contact our sales department.

Clamping force 60tf or less

High end

Vibration control

Power-saving

All-axis servo-driven

Equipped with E-touch II as standard

The RC-30 is the smallest model of Yushin's signature all-axis servo driven type take-out robots built for functionality, rigidity, and superior design. Sized for ultra-small molding machines with clamping forces of 60 tf or less, the RC-30 is equipped with an array of functions designed to preserve the quality of delicate micro-molded products from gentle release of products to product separation by cavity. The RC-30 is ideal for handling precision products such as connectors or gears, where the tiniest scratch is considered a defect. The traverse axis uses a reinforced lightweight aluminum frame.

Standard Specifications

Power supply		Drive method		Controller model		Working air pressure		Flip angle	
200/220 VAC (50/60 Hz) Single phase		Digital servo motor 3/5-axis		E-touch II		0.49MPa		90°	
Model	Power consumption	Traverse stroke (mm)	Kick stroke (mm)		Vertical stroke (mm)		Air consumption (NL/cycle)	Payload (kg)	Target IMM clamp capacity (tf)
			Main arm	Sub arm	Main arm	Sub arm			
RC-30S	1.7 kVA Single phase 200 VAC 8.5 A	900 (1200) (1600)	320 (470)	—	450	—	2.9 (ECO Vacuum OFF)	2	60 or less
RC-30D	2.2 kVA Single phase 200 VAC 10.8 A		280 (430)	280 (430)		550	1.0 (ECO Vacuum ON)		

S type : Robot is equipped with main arm only. D type : Robot is equipped with main arm and sub arm.  
( ) : Modified stroke  
Payload includes the end-of-arm tool.  
Traverse stroke modification and kick stroke modification are available as a combined option.

Separate catalog available

Rear (Non-operator) Side Discharge Direction (mm)

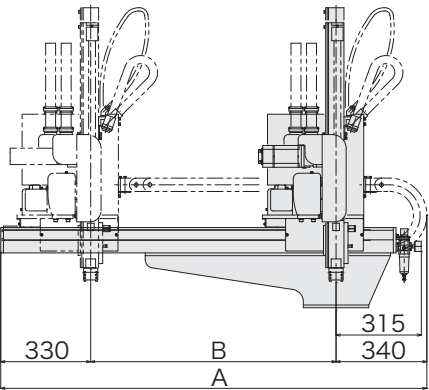
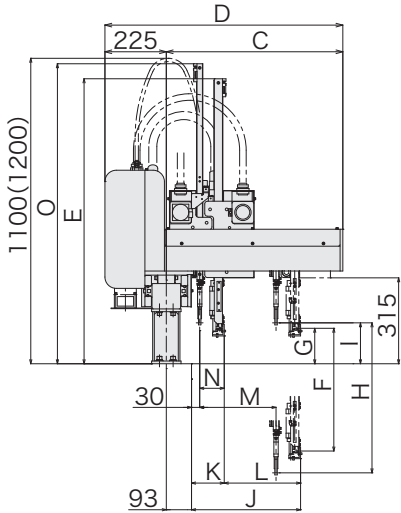

Operator Side Discharge Direction (mm)

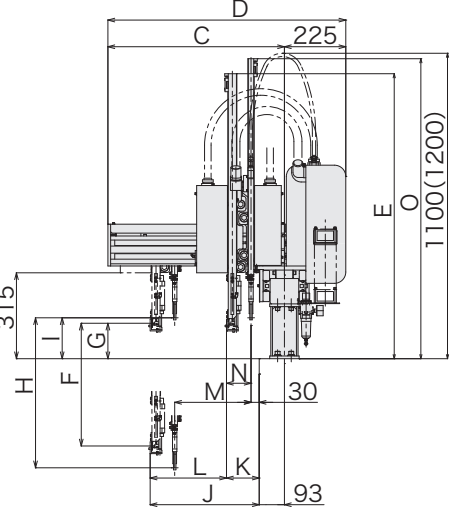
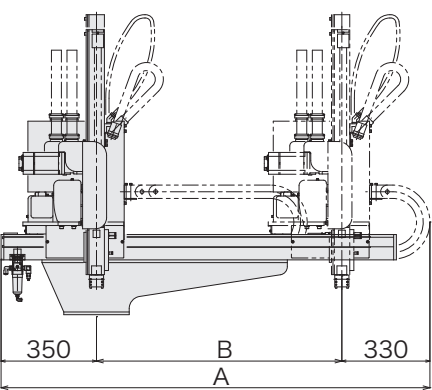

Model	A		B	C	D	E	F	G	H	I	J	K	L	M	N	O
	Operator Side Discharge Direction	Rear (Non-operator) Side Discharge Direction														
RC-30S	1580 (1880) (2280)	1570 (1870) (2270)	900 (1200) (1600)	648 (798)	873 (1023)	1045	450	130 (106) (30)	—	—	400 (550)	80	320 (470)	—	—	—
RC-30D									550	150		120	280 (430)	280 (430)	90	1100

( ) : Modified stroke  
< > : With increased wrist flip torque  
{ } : With horizontal wrist rotation unit

Controller (mm)

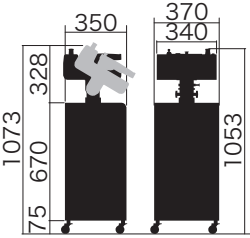

RC-30S/D

All-Axis Servo Driven Type Take-Out Robot

All-Axis Servo Driven Type

Single-Axis Servo Driven Type

Swing Type

Side Entry Type

For Vertical Molding Machine

Stock System

Product Series Guide [P11]