

# 1 All-Axis Servo Driven Type Take-Out Robot

YCII-800S/D, YCII-1300S/D-e

Separate catalog available

## YC II -800S/D, YC II -1300S/D-e

Lightweight, vibration-resistant, power-saving models now support easy introduction in low-clearance installations

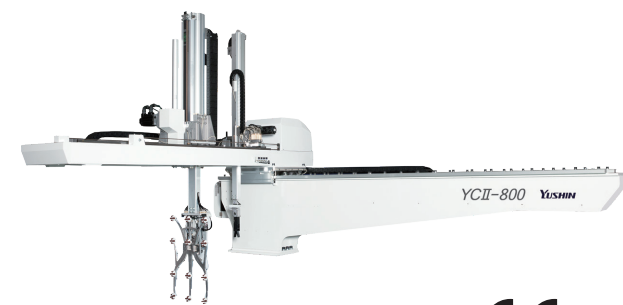

For CE supported languages. Please contact our sales department.



Clamping force 550 - 1600tf



Standard



Vibration control



Optimized design + Power-saving



Low posture (Double speed mechanism)



All-axis servo-driven

### All-Axis Servo Driven Take-Out Robot for Energy-Smart Manufacturers

YC series robots benefit from much lighter components and structures by incorporating design optimization technology. This weight reduction results in significantly better energy efficiency and longevity. Design optimization also targeted factors like natural oscillation and damping characteristics to greatly reduce arm vibration. The YCII-800/1300 models are sized for molding machines with clamping forces from 550 to 1600 tf.

### Equipped with E-touch compact-YC as standard



- ECO Vacuum®
- ECO Monitor®
- Predictive Maintenance\*

\* Continuously monitors take-out robot during operation and alerts operator with a message if any signs of potential trouble are detected.

#### Standard Specifications

Power supply		Drive method		Controller model		Working air pressure		Flip angle	
200/220 VAC (50/60 Hz) 3 phase		Digital servo motor 3/5-axis		E-touch compact-YC		0.49MPa		90°	
Model	Power consumption	Traverse stroke (mm)	Kick stroke (mm)		Vertical stroke (mm)		Air consumption (NL/cycle)	Payload (kg)	Target IMM clamp capacity (tf)
			Main arm	Sub arm	Main arm	Sub arm			
YCII-800S	S type 2.5 kVA 200 VAC 9.1 A	2000 (2500) (3000)	1140	—	1550 (1800)	—	29.0 (ECO Vacuum OFF)	25	550-1000
YCII-800D			960	960	—	1550 (1800)	20.0 (ECO Vacuum ON)		
YCII-1300S-e	D type 3.4 kVA 200 VAC 13.8 A	2500 (3000)	1540	—	1800	—	36.0 (ECO Vacuum OFF)	25	1000-1600
YCII-1300D-e			1360	1360	—	1800	24.0 (ECO Vacuum ON)		

S type : Robot is equipped with main arm only. D type : Robot is equipped with main arm and sub arm.

( ) : Modified stroke

Payload includes the end-of-arm tool.

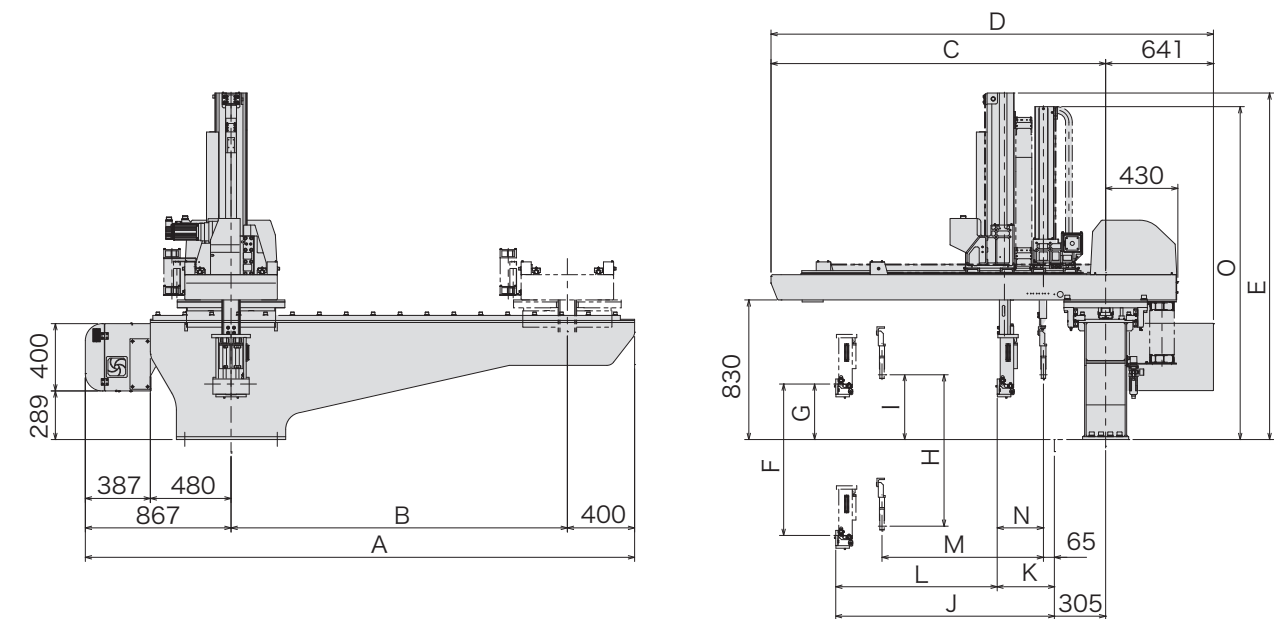

(mm)

Model	A	B	C	D	E	F	G	H	I	J	K	L	M	N	O
YCII-800S	3267 (3767) (4267)	2000 (2500) (3000)	1992	2633	2060 (2185)	1550 (1800)	330	—	—	1300	160	1140	—	—	—
YCII-800D								1550 (1800)	385		340	960	960	275	1980 (2105)
YCII-1300S-e	3767 (4267)	2500 (3000)	2392	3033	2185	1800	130	—	—	1700	160	1540	—	—	—
YCII-1300D-e								1800	185		340	1360	1360	275	2105

( ) : Modified stroke

### Introducing our EXTRA catalog

#### Needs on the molding work floor

- Flexible handling of products
- Flexible cutting of products
- Round-the-clock operation and better labor saving
- Changeover improvement

Yushin has the solution for you.



CATALOG YUSHIN

YCII-800S/D, YCII-1300S/D-e

All-Axis Servo Driven Type Take-Out Robot