

 Separate catalog available

All-Axis  
Servo Driven  
Type

Swing Type

Side Entry  
Type

For Vertical  
Molding  
Machine

Stock System

Product  
Series  
Guide [P11](#)

## YD-0310S/D

Enhanced design for higher productivity,  
less downtime, and lighter environmental footprint.

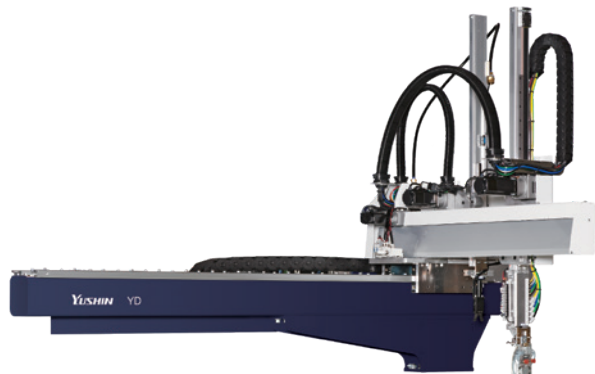

For CE supported languages,  
please contact our sales  
department.



Clamping  
force 30 - 100tf



Vibration  
control



Optimized design  
+ Power-saving



All-axis  
servo-driven

### All-Axis Servo Driven Take-out Robot Enhancing Customer Profitability and Environmental Measures

Combining design optimization, CFRPV3, and vibration control contribute to shorter cycle time and stable take-out.

We have refined our unique ECO Vacuum™ technology to reduce compressed air consumption even further. As a result, robot air consumption can be economized and can reduce capital expenditures. The YD-0310 is sized for small molding machines with clamping forces from 30 to 100 tf.

### Equipped with E-touch compact 3 as standard



- Smart ECO Vacuum
- Take-out Diagnosis Function
- Torque Monitoring during Manual Operation

The E-touch compact 3 takes the easy operability of the previous YC series controller. And several assist features to become even easier to use.

#### Standard Specifications

Power supply		Drive method		Controller model		Working air pressure		Flip angle	
200/220 VAC (50/60 Hz) Single phase		Digital servo motor 3/5-axis		E-touch compact 3		0.49MPa		90°	
Model	Power consumption	Traverse stroke [mm]	Kick stroke [mm]		Vertical stroke [mm]		Air consumption [NL/cycle]	Payload [kg]	Target IMM clamp capacity [tf]
			Main arm	Sub arm	Main arm	Sub arm			
YD-0310S	1.4 kVA 200 VAC 7.0 A	1100 (1400) (1700)	500	—	600 (700)	—	3.2 Smart ECO Vacuum OFF	3 《5》	30-100
YD-0310D	1.7 kVA 200 VAC 8.5 A		450	450	—	650 (750)	0.9 Smart ECO Vacuum ON		

S type : Robot is equipped with main arm only. D type : Robot is equipped with main arm and sub arm.  
( ) : Modified stroke ( ) : Increased maximum payload  
Payload includes the end-of-arm tool.

#### Rear (Non-operator) Side Discharge Direction (mm)

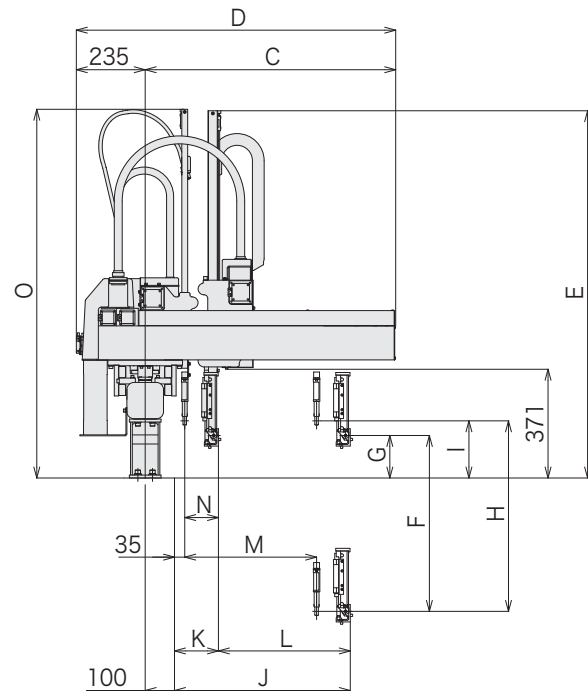

#### Operator Side Discharge Direction (mm)

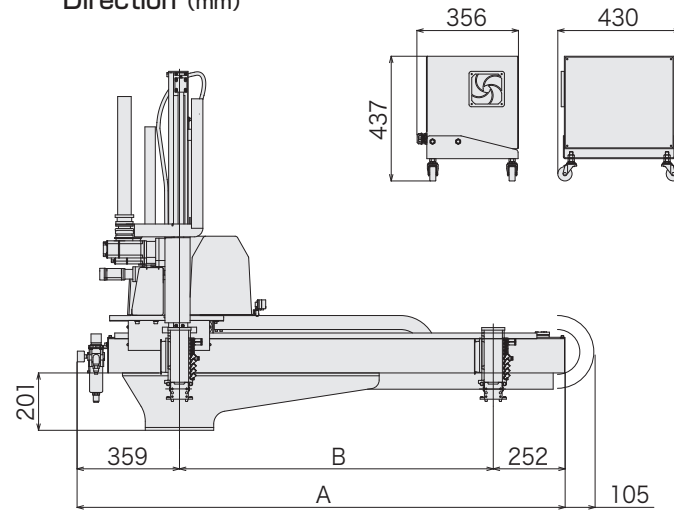

#### Control Box (mm)

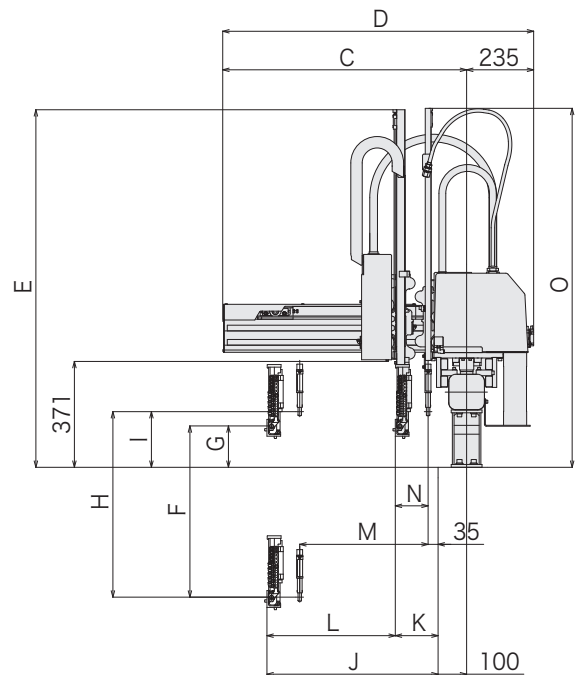
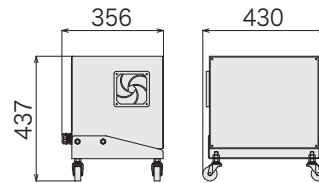

[mm]

Model	A	B	C	D	E	F	G	H
YD-0310S	1711 (2011)	1100 (1400)	855	1090	1253 (1353)	600 (700)	145	—
YD-0310D	—	—	—	—	—	—	—	650 (750)

Model	I	J	K	L	M	N	O
YD-0310S	—	600	100	500	—	—	—
YD-0310D	195		150	450	450	115	1258 (1358)

( ) : Modified stroke

All-Axis  
Servo Driven  
Type

Swing Type

Side Entry  
Type

For Vertical  
Molding  
Machine

Stock System

Product  
Series  
Guide [P11](#)